

## Features

- Freestanding design creates a striking focal point in your bathing area.
- Integral lumbar support on both ends.
- 18" (457 mm) depth offers a deep soaking experience.
- Wide deck along one side simplifies installation and provides support for getting in and out of bath.
- Fluted shroud.
- Textured bottom surface.
- Center drain.

## Material

- Acrylic.

## Installation

- Freestanding.

## Recommended Products/Accessories

K-7265 Brass toe tap bath drain  
K-37383 Rough-in cable bath drain, PVC, 30" cable with tubing  
K-37386 rough-in cable drain, PVC, 30" cable  
K-24916 Wireless Music Kit  
K-T37391 Rotary-turn bath drain trim  
K-T37392 Rotary-turn bath drain trim  
K-T37393 Rotary-turn bath drain trim  
K-T37394 Rotary-turn bath drain trim  
K-T37395 Bath drain trim  
K-T37396 Push-button bath drain trim  
K-T37397 Push-button bath drain trim  
K-37385 rough-in cable drain, PVC, 45" cable  
K-23726 Drain treatment  
K-23732 Tub & shower cleaner



## Codes/Standards



CSA B45.5/IAPMO Z124  
ASTM E162  
ASTM E662

## KOHLER® Hydrotherapy Components Five-Year Limited Warranty

See website for detailed warranty information.

## Available Colors/Finishes

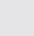
*Color tiles intended for reference only.*

Color	Code	Description
	0	White
	96	Biscuit

No change in measurements if connected with drain illustrated. (K-7265)

 Faucet area.

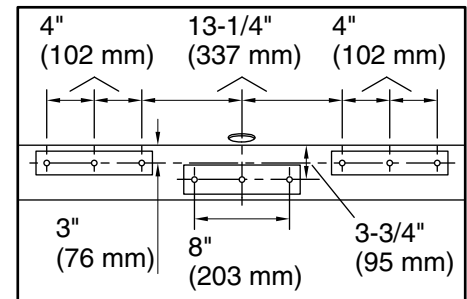
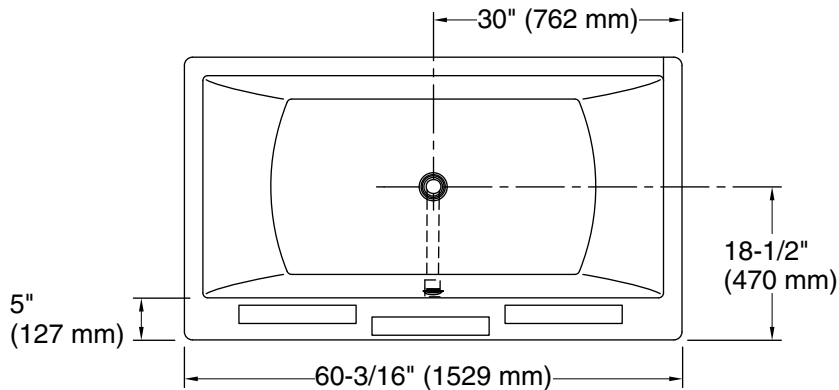

Recommended Faucet Hole Location

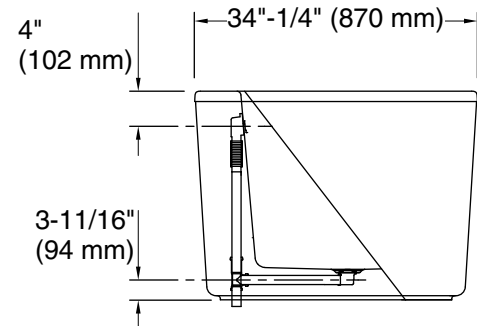
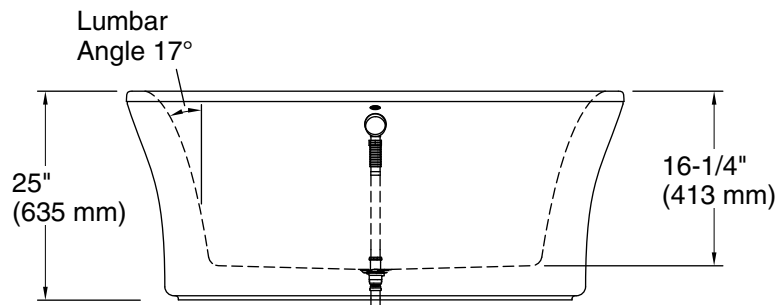

## Technical Information

All product dimensions are nominal.

Installation:	Freestanding
Drain location:	Center
Basin area, bottom:	40-5/16" x 22-1/2" (1024 mm x 572 mm)
Basin area, top:	49-3/8" x 25-7/8" (1254 mm x 657 mm)
Weight:	156 lbs (70.8 kg)
Minimum floor load:	54 lbs/ft² (263.7 kg/m²)
Water depth:	16-1/16" (408 mm)
Water capacity:	60 gal (227.1 L)
Template:	Footprint, 1364290, not required, not included

## Notes

Measure your actual product for rough-in details.

Install this product according to the installation instructions.

The hot water supply should be 70% of the capacity of the bath or greater. Installations will vary.